

## COUNTY STAND

## PREMIER SUITE

Fresh, contemporary and ever so stylish, the Premier Suite is suited for both dinners and conferences of up to 350 guests. It even has its own conservatory to the rear which is the perfect spot for drinks receptions. As this suite is located on the second floor, it has direct access to the Tommy Whittle Stand's six syndicate rooms and thirty boxes, it's ideal for multi-room conferences or exhibitions.



THEATRE

200



BOARDROOM

45



CABARET

120



CLASSROOM

80



DINNER

250



DINNER DANCE

220



U SHAPE

-



RECEPTION

350



FLOOR PLAN

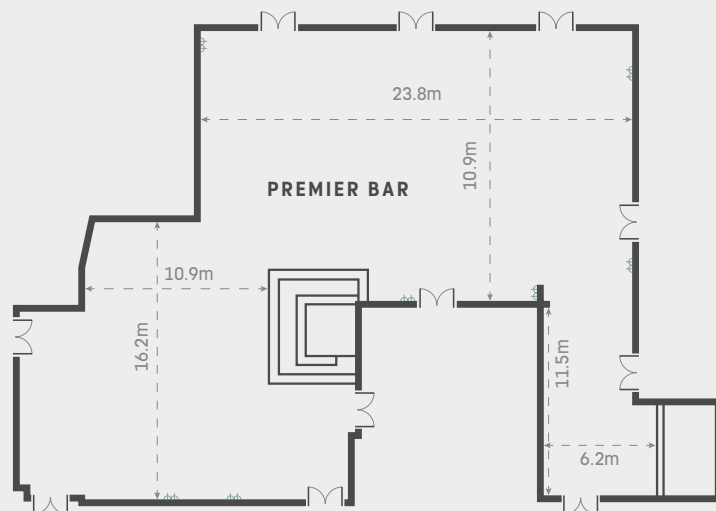

13A SOCKET

--- USEABLE SPACE DIMENTIONS

CONTACT US ON: 01942 402623 | NORTHWESTEVENTS@THEJOCKEYCLUB.CO.UK