

Aintree

RACECOURSE

UNIQUE EVENTS

AN ICONIC VENUE



QUEEN MOTHER STAND:

BECHER'S SUITE

Most certainly the most famous of the Grand National fences, Becher's Brook was named after Captain Mark Becher who fell at the fence in the first Grand National in 1839 and took refuge in the small brook running along the landing side of the fence.

With views of the winning post, the Becher's Suite can accommodate up to 150 delegates theatre style or up to 50 for a board meeting.

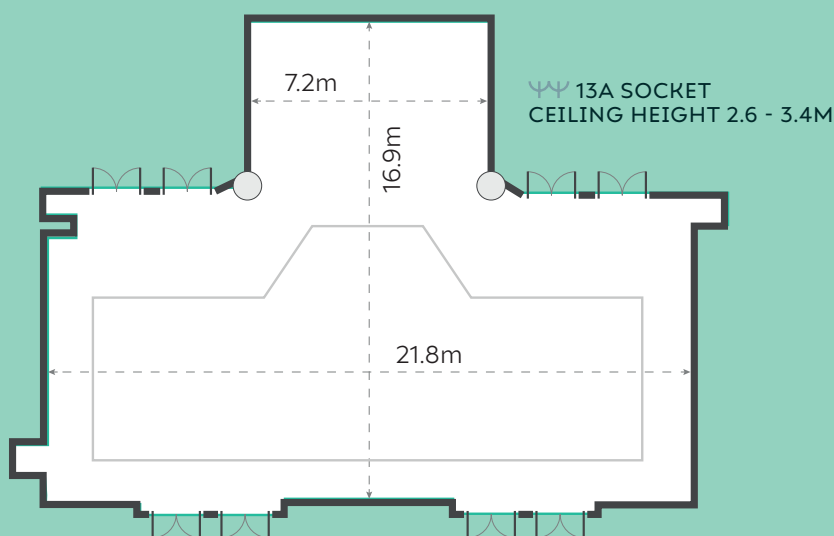

Stats at a glance...

	THEATRE	150
	BOARDROOM	50
	CABARET	60
	CLASSROOM	60
	DINNER	120
	DINNER DANCE	100
	U SHAPE	-
	RECEPTION	120

CONTACT US ON: 0151 522 2922

NORTHWESTEVENTS@THEJOCKEYCLUB.CO.UK

